

TODDY® TIMER - User Guide

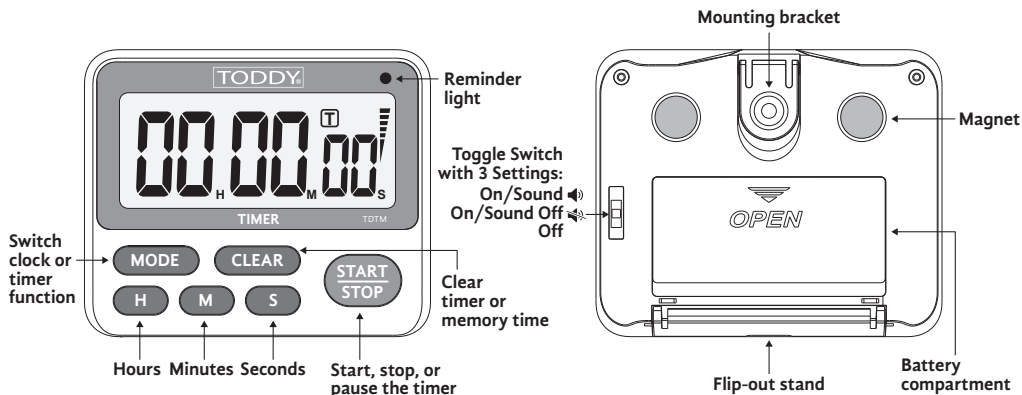

BEFORE FIRST USE

1. Remove protective film on screen by freeing one corner and then pulling remainder off.
2. Install 2 AAA batteries (included). Access battery compartment by sliding cover in the direction of the arrow.
3. Turn the timer on with the switch on the back.

TO USE AS A TIMER

1. Press **MODE** button to enter **TIMER MODE**.
2. Press **H** button to set hours. (Press and hold to increase quickly.)
3. Press **M** button to set minutes.
4. Press **S** button to set seconds.
5. Press the **CLEAR** button to reset the timer. Press again to load memory time (last countdown time started).

START COUNTDOWN

1. After setting the countdown time, press **START/STOP** button to begin countdown. Pressing this button repeatedly will cycle between pausing and resuming the countdown.

2. When the countdown timer reaches zero, the indicator light will flash, the alarm will sound (if turned on for 1 minute), and the timer will begin to count up while flashing.
3. Press **START/STOP** button to return to timer mode.

TIMER PLACEMENT

This product can stand on its own with use of the flip-out stand, hang on a fixture with the mounting bracket, or attach to a magnetic metal surface with rear magnets.

TO USE AS A CLOCK

1. Press **MODE** until the display reads **CLOCK**.
2. Press **H** button to set hours. (Press and hold to increase quickly.)
3. Press **M** button to set minutes.
4. Press **S** button to set seconds.

BATTERY REPLACEMENT

Replace batteries if display is dim or unclear.

IMPORTANT

- ▶ Timer is not water-resistant. Do not immerse in water or expose to liquids. Surface clean only.
- ▶ Do not expose the timer to heat, which may cause deformation or damage.
- ▶ Remove batteries prior to storage to prevent potential damage to internal components.



ONE YEAR LIMITED WARRANTY

Toddy, LLC warrants this product to be free from defects in material or workmanship (excluding batteries) for 1 year from the original date of purchase.